

Block No.	Ref. No.	Part No.	Description	Reqd. No. CB400 F F1 F2	Serial No.	Area Code
	321	94001-10000-0S	NUT, HEX., 10MM	1 1 1		
	322	94002-08000-0S	NUT, HEX., 8MM	2 2 2		
	323	94101-05000	WASHER, PLAIN, 5MM	3 3 3		
	324	94101-06000	WASHER, PLAIN, 6MM	1 1 1		
	325	94109-12000	WASHER, DRAIN PLUG, 12MM	1 1 1		
	326	94109-14000	WASHER, DRAIN PLUG, 14MM	4 4 4		
	327	94111-05000	WASHER, SPRING, 5MM	8 8 8		
	328	94111-06000	WASHER, SPRING, 6MM	2 2 2		
	329	94301-08100	PIN A, DOWEL, 8X10	2 2 2		
	330	94301-08140	PIN A, DOWEL, 8X14	8 8 8		
	331	94301-10140	PIN A, DOWEL, 10X14	2 2 2		
	332	94301-12200	PIN A, DOWEL, 12X20	4 4 4		
	333	94301-14200	PIN A, DOWEL, 14X20	2 2 2		
	334	94302-06100	PIN B, DOWEL, 6X10	1 1 1		
	335	94520-52000	CIR CLIP, INTERNAL, 52	3 3 3		
	336	94601-13000	CLIP, PISTON PIN, 13MM	8 8 8		
	337	95001-35600-40	TUBE, FUEL, 3.5X600	2 2 2		
	338	95002-02070	CLIP B7, TUBE	6 6 6		
	339	95005-11470-30	TUBE, 11X470	1 1 1		
	340	95700-06016-00	BOLT, FLANGE, 6X16	3 3 3		
	341	95700-06020-00	BOLT, FLANGE, 6X20	4 4 4		
	342	95700-06028-00	BOLT, FLANGE, 6X28	11 11 11		
	343	95700-06032-00	BOLT, FLANGE, 6X32	10 10 10		
	344	95700-06035-00	BOLT, FLANGE, 6X35	2 2 2		
	345	95700-06040-00	BOLT, FLANGE, 6X40	19 19 19		
	346	95700-06060-00	BOLT, FLANGE, 6X60	8 8 8		
	347	95700-06090-00	BOLT, FLANGE, 6X90	3 3 3		
	348	95700-06100-00	BOLT, FLANGE, 6X100	1 1 1		
	349	95700-08032-00	BOLT, FLANGE, 8X32	1 1 1		
	350	95800-06055-00	BOLT, FLANGE, 6X55	1 1 1		
	351	96100-62050	BEARING, RADIAL BALL, 6205	2 2 2		
	352	96220-40118	ROLLER, 4X11.8	1 1 1		
	353	96220-40218	ROLLER, 4X21.8	1 1 1		
	354	98069-38710	PLUG, SPARK (D-8ES-L NGK)	4 4 4		A, E, G, F, ED
		98069-38716	PLUG, SPARK (DR8ES-L NGK)	4	2103573	CM
		98069-58726	PLUG, SPARK (X24ESR-U ND)	4	2103573	CM
	356	99124-076-0380	JET, SLOW #38	(4) (4) (4)		
		99124-076-0400	JET, SLOW #40 (STD.)	4 4 4		
		99124-076-0420	JET, SLOW (#42)	(4) (4) (4)		
	357	99202-601-0720	JET SET, MAIN (#72)	(4) (4) (4)		
		99202-601-0750	JET SET, MAIN (#75) (STD.)	4 4 4		
		99202-601-0780	JET SET, MAIN (#78)	(4) (4) (4)		

FRAME GROUP

CB400F-F1-A TYPE

1

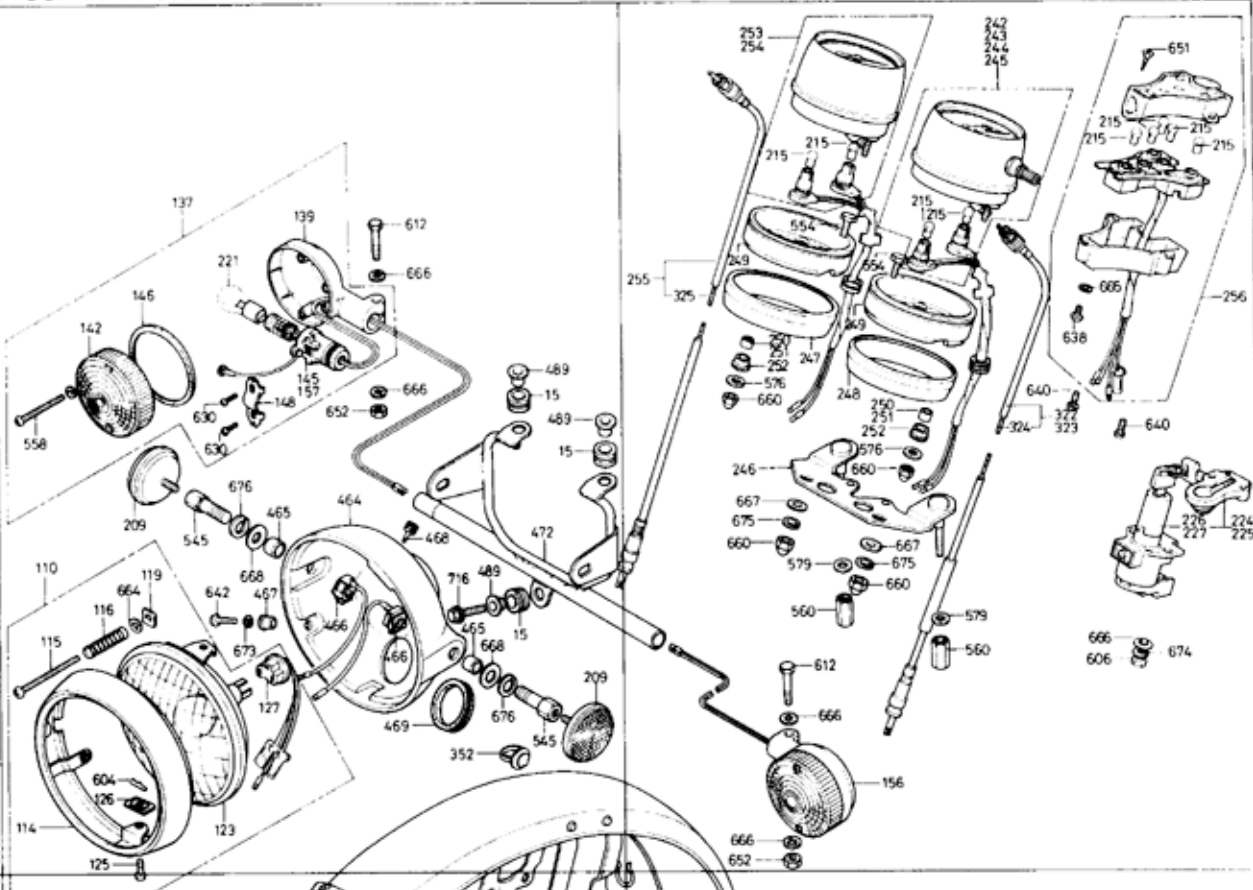

2

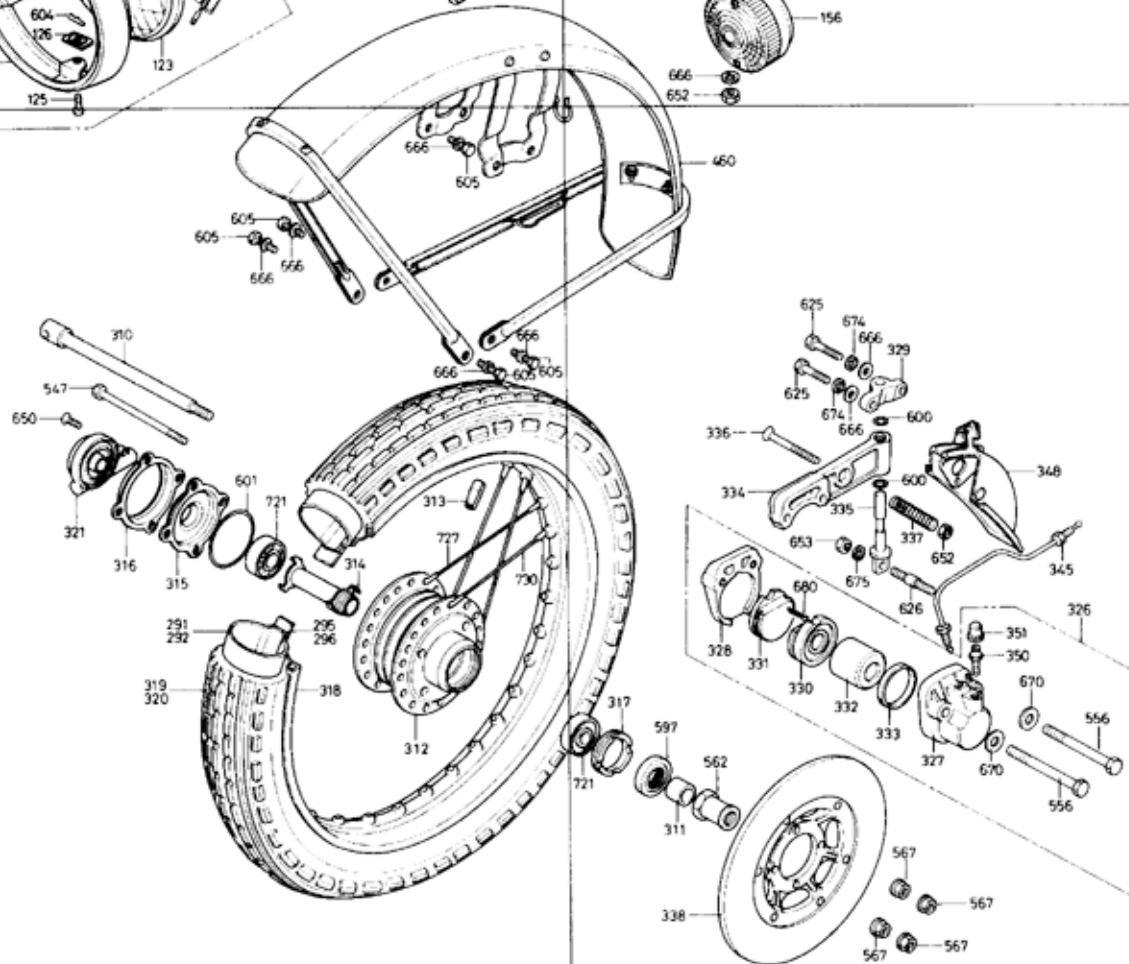

BLOCK
NO.

A

B

FRAME GROUP

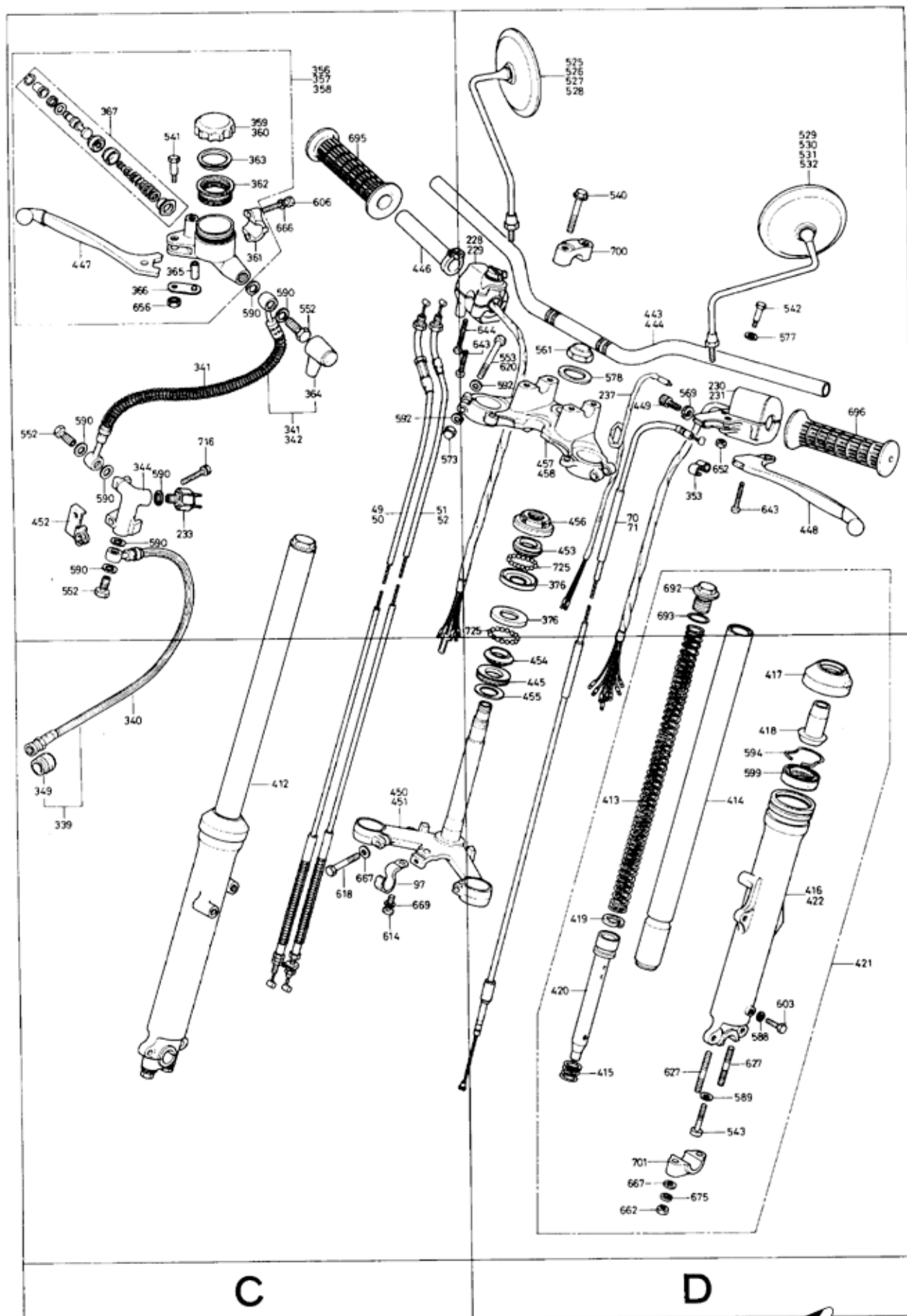

1



F

FRAME GROUP

CB400F-F1-A TYPE

1

2

BLOCK
NO.

J

K

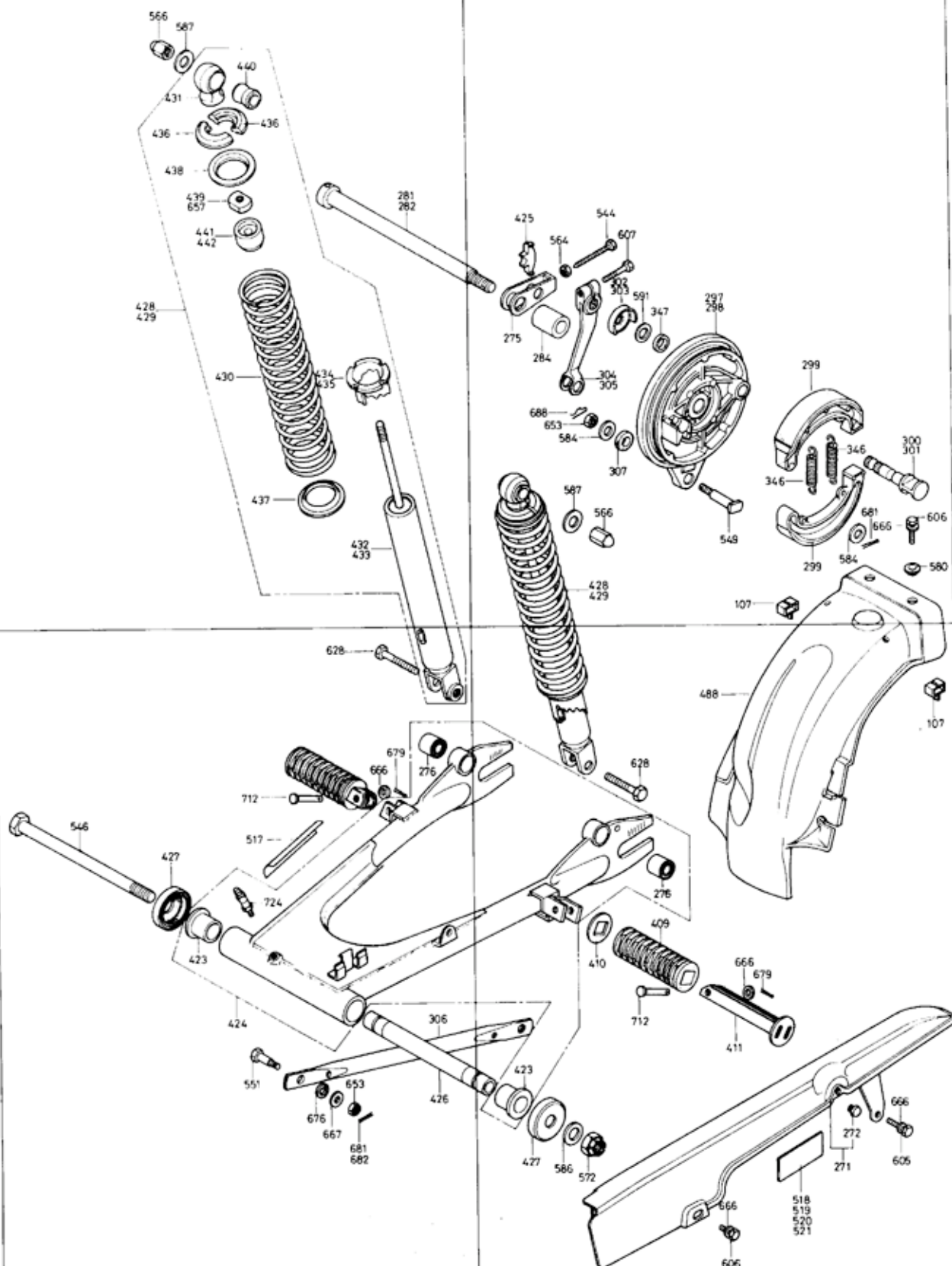

FRAME GROUP

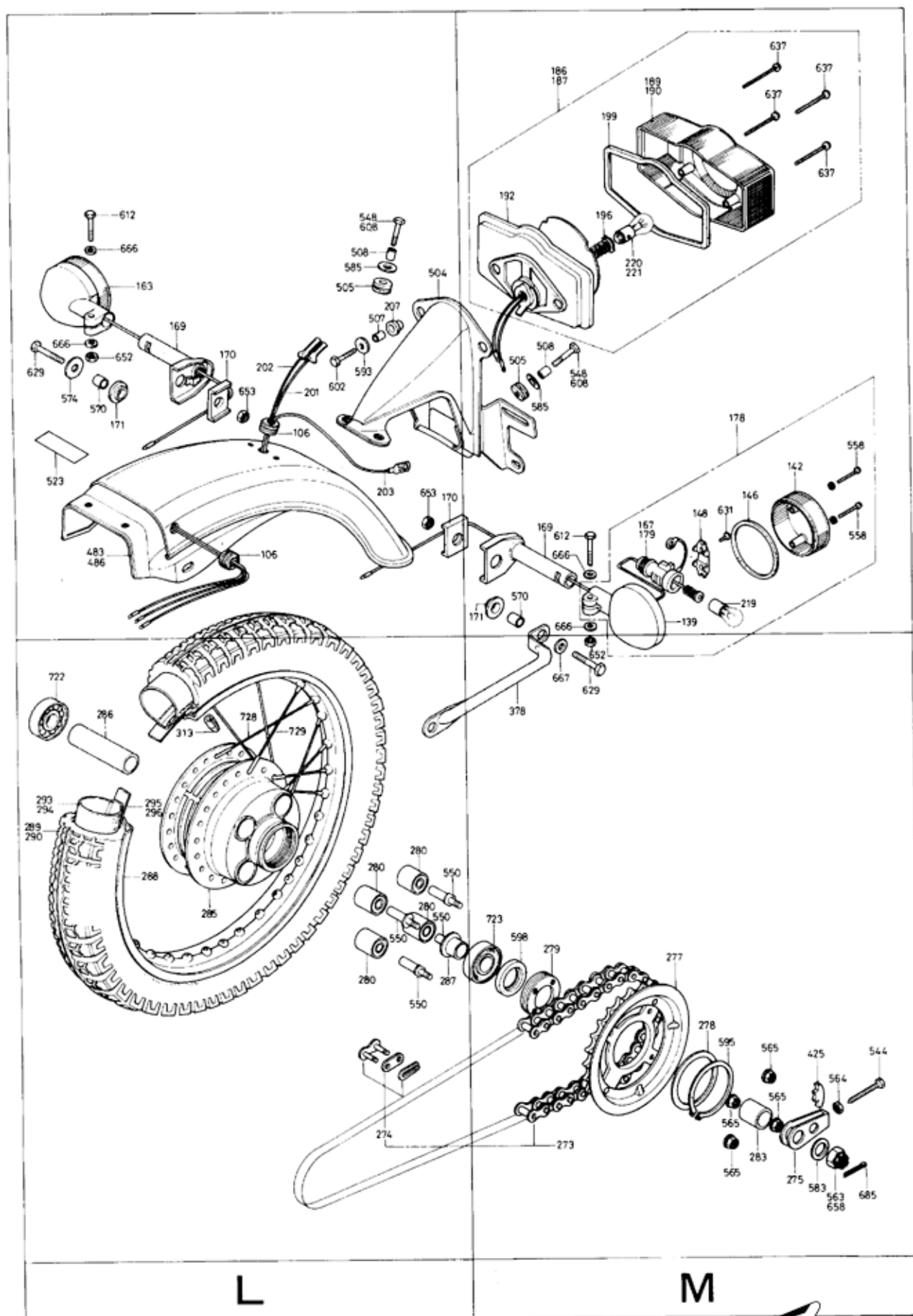

FRAME GROUP

Exclusive parts for each area

(Only exclusive parts for each type are described in the following illustrations.)
(Therefore, refer to the basic CB400F·F1-A type illustration for the parts not shown in these illustrations.)

CB400F·F1·F2-E TYPE

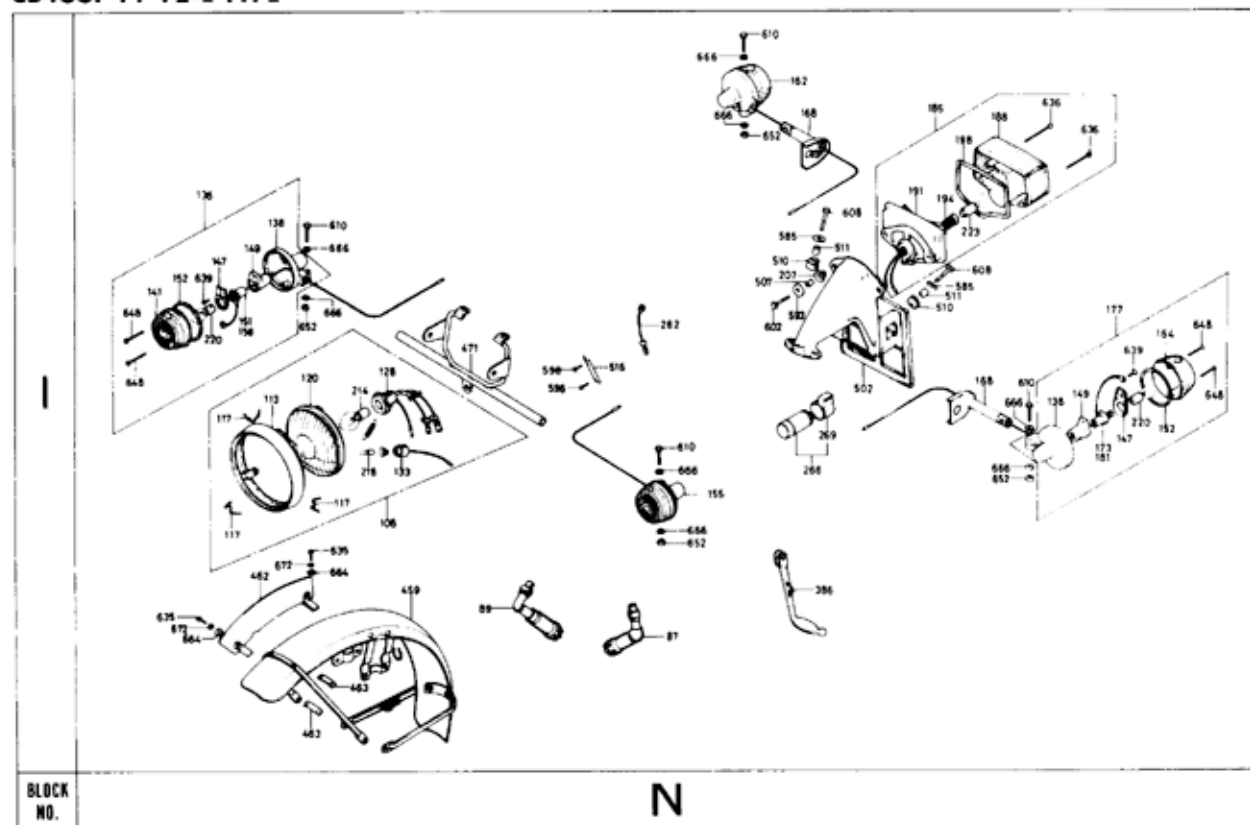

BK377-14

CB400F·F1·F2-G TYPE

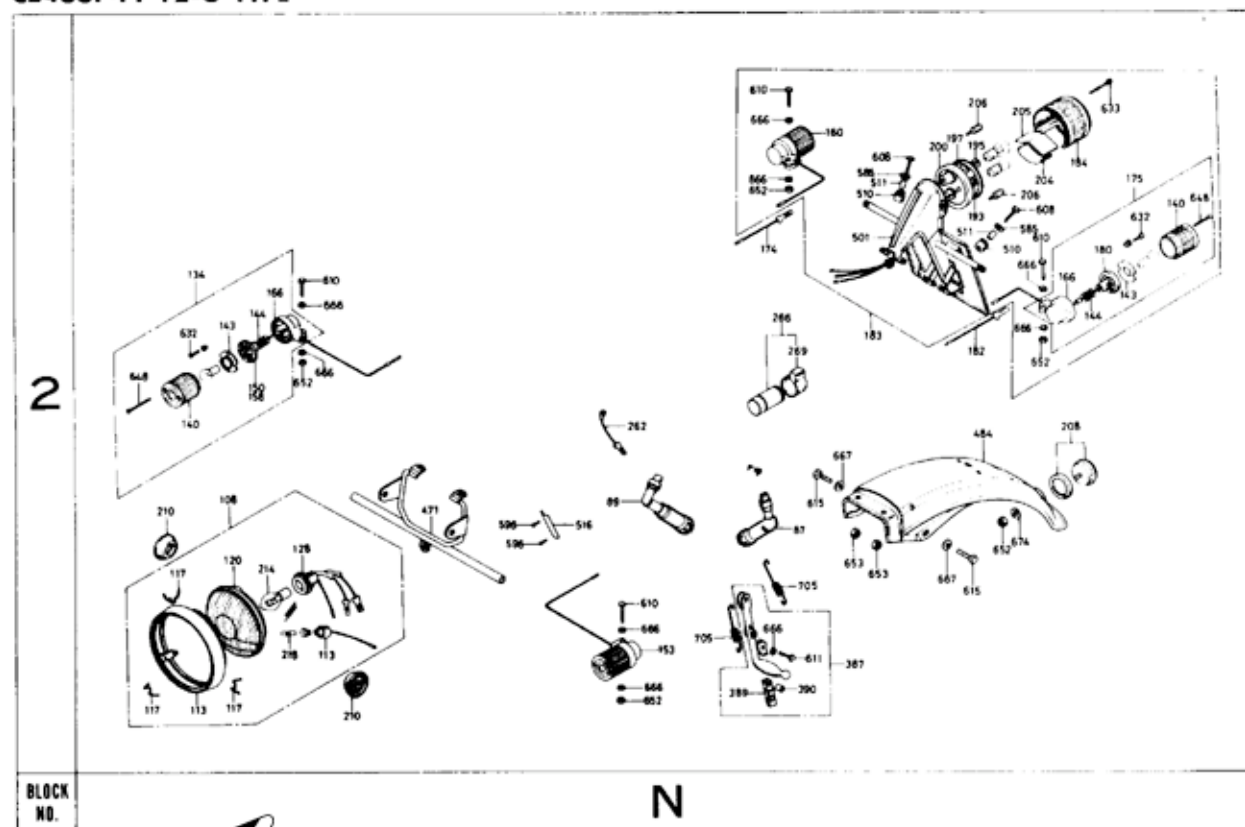

BK377-12

CB400F-F1-F2-ED-S TYPE

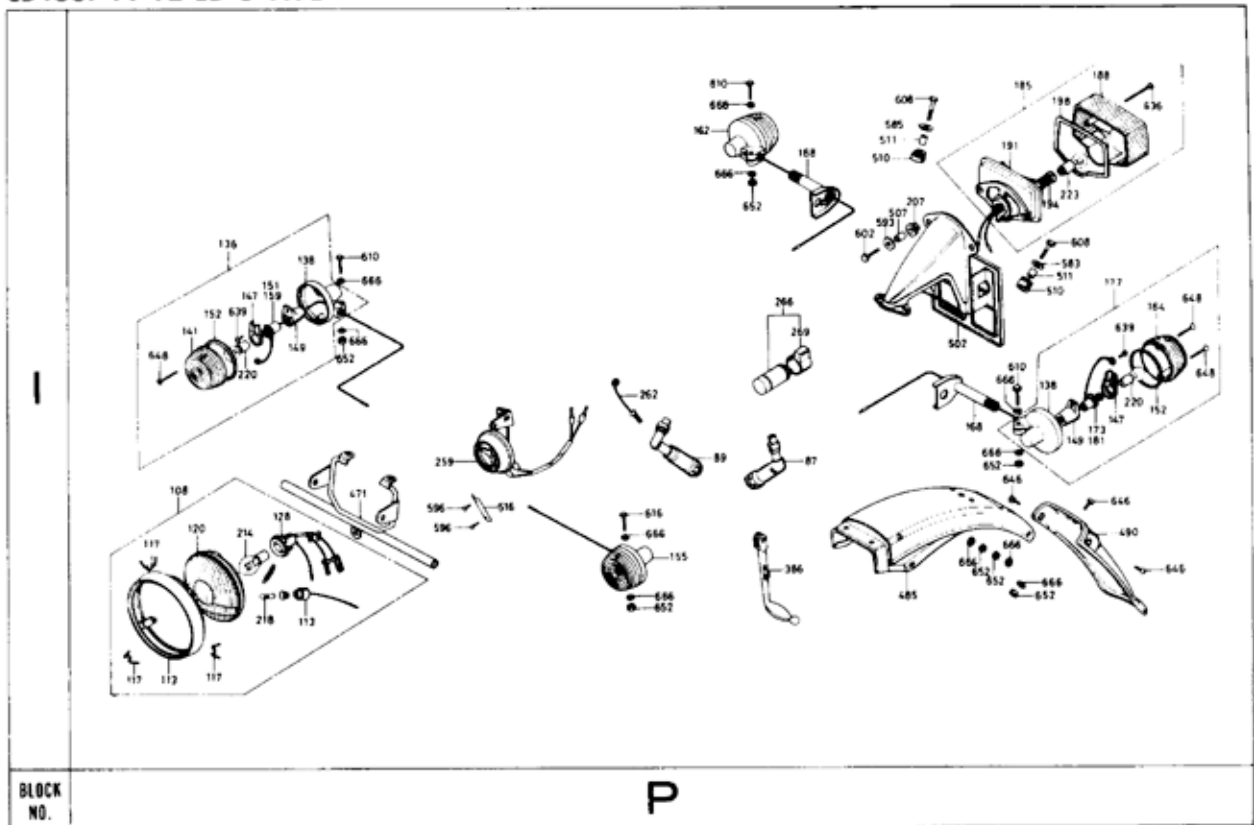

BK377-10

CB400F-F1-F2-DK-DM-U TYPE

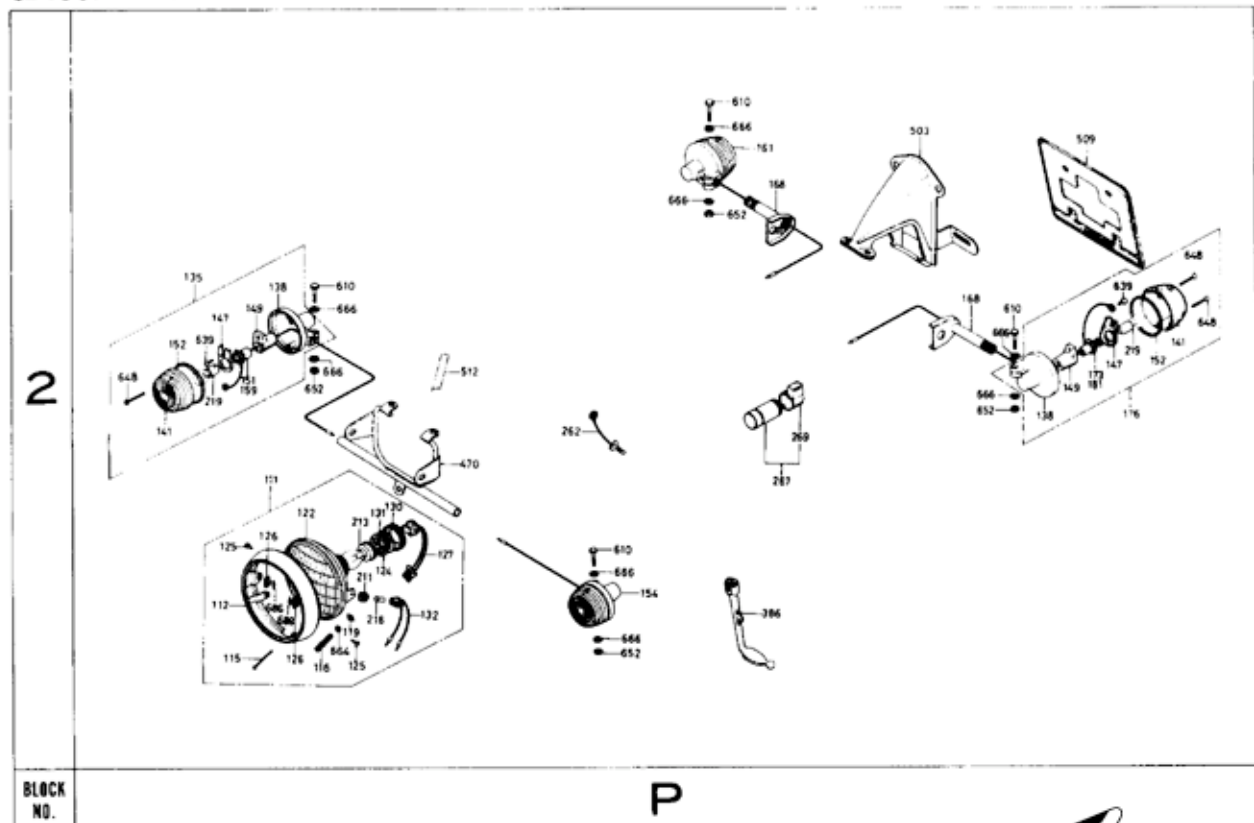

FRAME GROUP

Exclusive parts for each area

CB400F-F1-F2-F TYPE

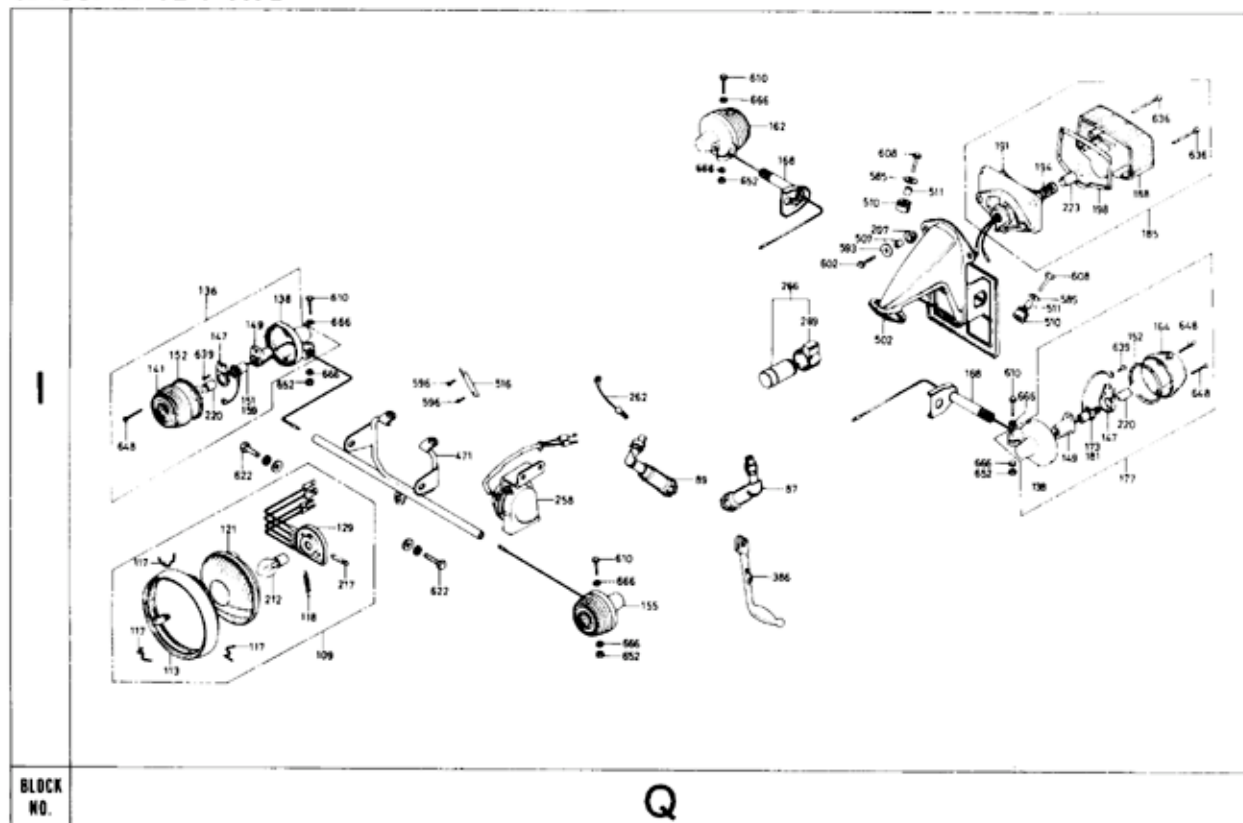

BK377-11

CB400F-F1-F2-E-ED-F-G-S TYPE

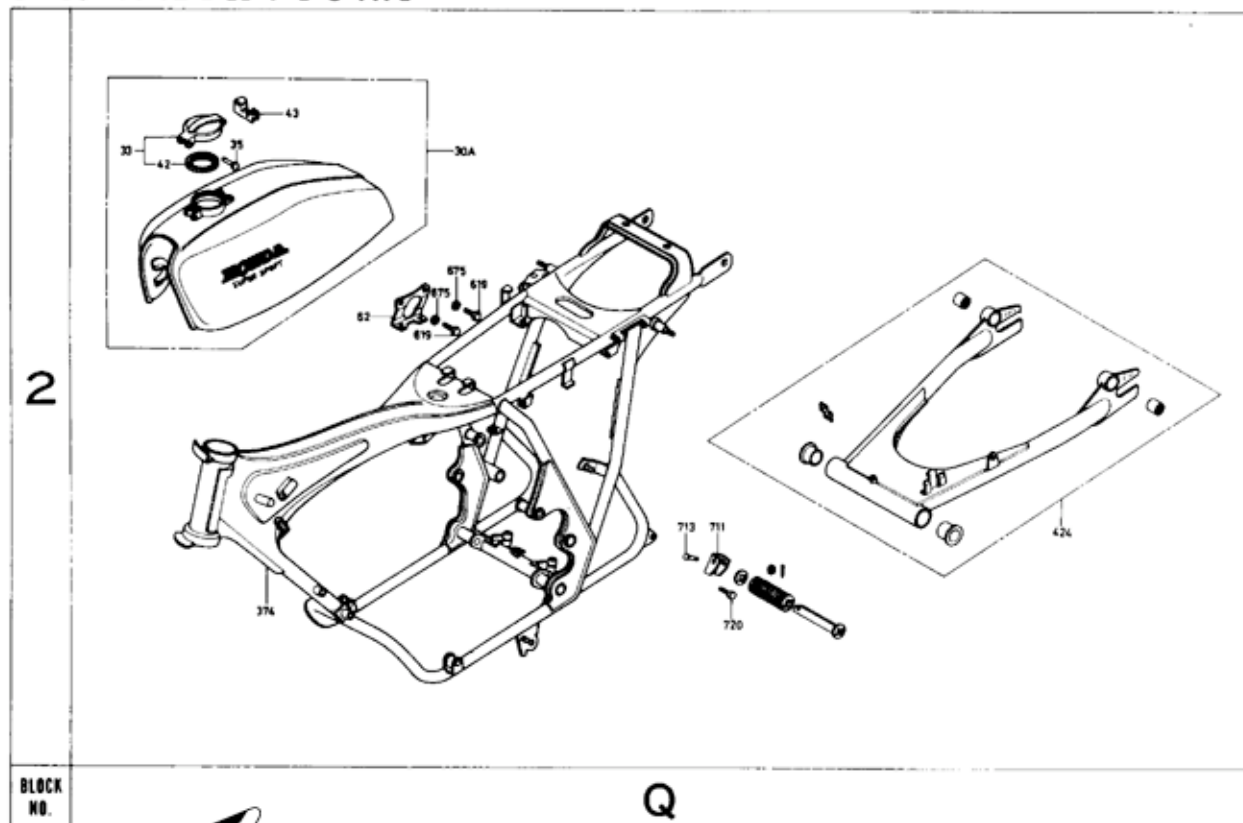

BK377-15

Exclusive parts for each area

FRAME GROUP

(The following illustration is only described exclusive parts for CB400F2-A type and based on CB400F-F1-A type.)

CB400F2-A TYPE

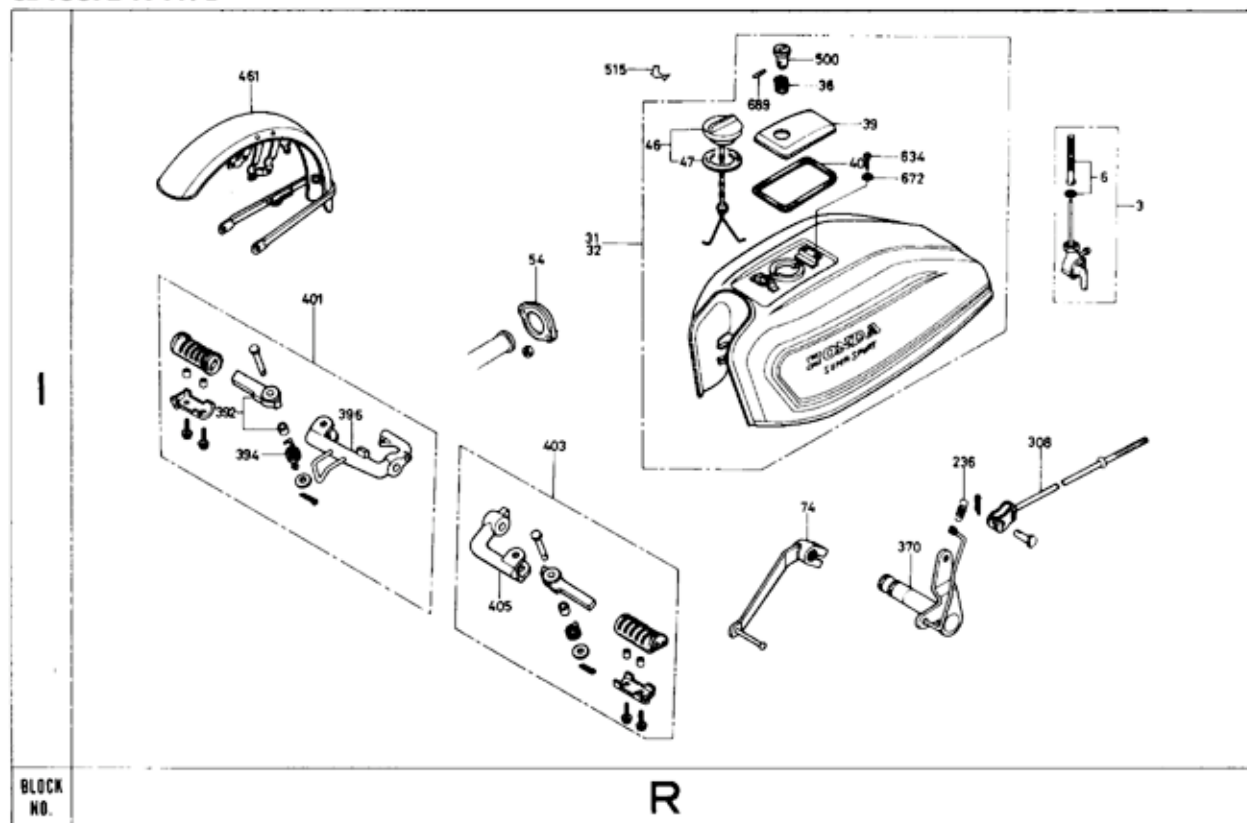

BK377-01

FRAME GROUP

Ref. No. 1 ~ 35

Block No.	Ref. No.	Part No.	Description	Reqd. No. CB400 F F1 F2	Serial No.	Area Code
2G	1	15772-292-010	CLIP, BREATHER TUBE	3 3 3		
1F	2	16950-377-005	COCK, FUEL (KEIHIN)	1 1 1		A,CM,DK,DM,U E,ED,F,G,S
1R	3	16950-377-701	COCK ASSY., FUEL	1		A,CM
1F	4	16951-377-005	BODY SET, FUEL COCK (KEIHIN)	1 1 1		A,CM,DK,DM,U E,ED,F,G,S
1F	5	16952-341-671	STRAINER SET	1 1 1		A,CM,DK,DM,U E,ED,F,G,S
1R	6	16952-377-701	SCREEN SET, FUEL STRAINER	1		A,CM
1H	7	17210-333-610	ELEMENT, AIR CLEANER	1 1 1		
1H	8	17216-333-010	SPRING, CLEANER ELEMENT	1 1 1		
1H	9	17230-377-010	CASE COMP., AIR CLEANER	1 1 1		
2G	10	17235-333-000	GUIDE, AIR DUCT	1 1 1		
2G	11	17236-333-000	SEAL, AIR CLEANER ELEMENT	1 1 1		
1H	12	17240-333-000	DUCT, AIR CLEANER IN.	1 1 1		
1H	13	17241-333-000	NET, AIR IN.	1 1 1		
1H	14	17242-333-000	BAND, AIR CLEANER IN.	1 1 1		
1A	15	17245-107-010	RUBBER, AIR CLEANER CASE MOUNTING	7 7 7		
1G	16	17245-369-000	GROMMET, SIDE COVER	2 2 2		
1G	17	17252-333-000	PLATE, BATTERY HINGE	1 1 1		
1G	18	17253-377-000	BRACKET, SIDE COVER	1 1 1		
2G	19	17255-333-000	BAND A, AIR CLEANER CONNECTING TUBE	4 4 4		
2G	20	17256-333-000	BAND B, CLEANER CONNECTING TUBE	1 1 1		
1H	21	17260-333-000	LID, AIR CLEANER CASE	1 1 1		
2H	22	17271-611-010	CHAMBER, BREATHER	1 1 1		
2H	23	17272-377-000	PACKING, BREATHER	1 1 1		
2G	24	17300-333-000	CHAMBER ASSY., AIR CLEANER	1 1 1		
2G	25	17335-323-000	TUBE ASSY., BREATHER	1 1 1		
1H	26	17352-377-000	ELEMENT U	1 1 1		
1H	27	17354-377-000	PLATE A, PANCHING	1 1 1		
1H	28	17355-377-000	PLATE B, PANCHING	1 1 1		
2H	29	17358-374-000	TUBE ASSY., DRAIN	1 1 1		
1E	30	17500-377-670HX	TANK ASSY., FUEL	1 1	1073399	E,ED,F,G,S A,DK,DM,U
		17500-377-670MW	TANK ASSY., FUEL	1 1	1073399	E,ED,F,G,S A,DK,DM,U
2Q	30A	17500-377-600ZA	TANK ASSY., FUEL *R-6C-S*	1	1073400	E,ED,F,G,S
		17500-377-600ZB	TANK ASSY., FUEL *Y-31*	1	1073400	E,ED,F,G,S
1R	31	17500-377-720ZA	TANK ASSY., FUEL *R-6C-S*	1		A,CM
		17500-377-720ZB	TANK ASSY., FUEL *Y-31*	1		A,CM
1R	32	17500-377-770HX	TANK ASSY.	1		
		17500-377-770QE	TANK ASSY.	1		
1E	33	17510-323-310	CAP COMP., FUEL TANK	1 1 1		A,CM,DK,DM,U E,ED,F,G,S
1E	34	17513-300-300	PIN, FUEL FILLER CAP CHECK	1 1 1		A,CM,DK,DM,U E,ED,F,G,S
1E	35	17514-323-300	PIN B, FUEL FILLER CAP	1 1 1		A,CM,DK,DM,U E,ED,F,G,S



Block No.	Ref. No.	Part No.	Description	Reqd. No. CB400 F F1 F2	Serial No.	Area Code
1E	36	17515-300-300	SPRING, FUEL FILLER CAP CHECK	1 1 1		A,CM,DK,DM,U E,ED,F,G,S
1R	37	17516-383-670	SPRING B, FUEL TANK LID	1		A,CM
1E	38	17517-300-340	CHECK, FUEL FILLER CAP	1 1 1		A,CM,DK,DM,U E,ED,F,G,S
1R	39	17520-377-720ZA	LID COMP., FUEL TANK *NH-1*	1		A,CM
1R	40	17522-377-720	PACKING, TANK LID	1		A,CM
1F	41	17531-377-000	SPRING, FUEL TUBE COVER	1 1 1		
1E	42	17534-323-300	GASKET, FUEL FILLER CAP	1 1 1		A,CM,DK,DM,U E,ED,F,G,S
2Q	43	17550-377-601	CHECK ASSY., CAP	1	1073400	E,ED,F,G,S
1E	44	17611-286-000	CUSHION, FUEL TANK FR.	2 2 2		
1F	45	17613-377-000	CUSHION, FUEL TANK RR.	1 1 1		
1R	46	17620-377-720	CAP COMP., FUEL FILLER	1		A,CM
1R	47	17631-329-000	PACKING, FUEL FILLER CAP	1		A,CM
1F	48	17681-377-000	TUBE, FUEL	1 1 1		
1C	49	17910-377-000	CABLE COMP. A, THROTTLE	1 1 1		A,CM,DK,DM,U E,ED,F,G,S
1C	50	17910-377-710	CABLE COMP. A, THROTTLE	1		A,CM
1C	51	17920-377-000	CABLE COMP. B, THROTTLE	1 1 1		A,CM,DK,DM,U E,ED,F,G,S
1C	52	17920-377-710	CABLE COMP. B, THROTTLE	1		A,CM
2G	53	18231-333-010	JOINT, EX. PIPE	4 4 4		A,CM,DK,DM,U E,ED,F,G,S
1R	54	18231-377-720	JOINT, EX. PIPE	4		A,CM
2G	55	18233-107-000	COLLAR, EX. PIPE JOINT	8		A,CM
2G	56	18233-303-010	COLLAR, EX. PIPE JOINT	8 8 8		A,CM,DK,DM,U E,ED,F,G,S
2G	57	18291-028-000	GASKET, EX. PIPE	4 4 4		
2H	58	18300-377-305	MUFFLER COMP., EX.	1 1 1		
2H	59	18310-377-003	MUFFLER COMP., R.	1 1 1	1066239 2100806	DK,DM,E,ED,F,G,S,U A,CM A,CM
		18310-377-013	MUFFLER COMP.	1 1 1	1066240 2100807	DK,DM,E,ED,F,G,S,U A,CM
2G	60	18320-377-000	PIPE 1, EX.	1 1 1		
2G	61	18340-377-305	JOINT COMP., MUFFLER	1 1 1	1066239 2100806	DK,DM,E,ED,F,G,S,U A,CM A,CM
		18340-377-315	JOINT COMP., MUFFLER	1 1 1	1066240 2100807	DK,DM,E,ED,F,G,S,U A,CM
2Q	62	18353-377-610	BRACKET, MUFFLER	1 1	1056883	E,ED,F,G,S
1E	63	18362-720-000	NUT, FLANGE, 6MM	6 6 6		
2H	64	18372-319-300	BAND, MUFFLER	1 1 1		
2H	65	18391-292-300	PACKING, MUFFLER	1 1 1		
2G	66	18391-375-000	PACKING, MUFFLER	2 2 2		
2G	67	18420-377-000	PIPE 3, EX.	1 1 1		
2G	68	18431-375-000	BAND, R. PRE CHAMBER	1 1 1		
2G	69	18434-375-000	BAND, L. PRE CHAMBER	1 1 1		
1D	70	22870-377-000	CABLE COMP., CLUTCH	1 1 1		A,CM,DK,DM,U E,ED,F,G,S

FRAME GROUP

Ref. No. 71 ~ 105

Block No.	Ref. No.	Part No.	Description	Reqd. No. CB400 F F1 F2	Serial No.	Area Code
1D	71	22870-377-710	CABLE COMP., CLUTCH	1		A,CM
1E	72	22872-356-000	CLAMP, CLUTCH WIRE	1 1 1		
2E	73	24700-377-000	PEDAL COMP., GEAR CHANGE	1 1 1		A,CM,OK,DM,U E,ED,F,G,S
1R	74	24700-377-720	PEDAL COMP., GEAR CHANGE	1		A,CM
		24701-377-720	PEDAL, GEAR CHANGE	1		A,CM
2E	75	24710-377-000	ARM COMP., GEAR CHANGE	1 1 1		A,CM,OK,DM,U E,ED,F,G,S
2E	76	28241-333-010	JOINT, KICK ARM	1 1 1		
2E	77	28293-333-000	CLIP, KICK STARTER ARM	1 1 1		
2E	78	28294-333-000	WASHER, KICK ARM	1 1 1		
2E	79	28300-377-000	ARM COMP., KICK STARTER	1 1 1		
2E	80	28301-377-000	ARM, KICK STARTER	1 1 1		
2E	81	28305-333-010	CAP, KICK ARM	1 1 1		
2E	82	28311-329-000	RUBBER, KICK STARTER	1 1 1		
2E	83	28333-333-000	SPRING, KICK STARTER STOPPER	1 1 1		
1E	84	30510-333-013	COIL ASSY., R. IGNITION	1 1 1		
1E	85	30520-333-013	COIL ASSY., L. IGNITION	1 1 1		
1E	86	30700-300-010	CAP ASSY. A, NOISE SUPPRESSOR	2 2 2		A,CM,OK,DM,U A
		30700-405-153	CAP ASSY. A, NOISE SUPPRESSOR	2	2103567	CM
1N	87	30700-341-620	CAP ASSY. A, NOISE SUPPRESSOR	2 2		E,ED,F,G,S
1E	88	30701-323-013	CAP ASSY. C, NOISE SUPPRESSOR	2 2		1054104 OK,DM,U A
		30701-323-023	CAP ASSY. C, NOISE SUPPRESSOR	2 2 2	1054105 2008021	OK,DM,U A
		30700-390-153	CAP ASSY. C, NOISE SUPPRESSOR	2	2103567	CM
1N	89	30701-323-622	CAP ASSY. C, NOISE SUPPRESSOR	2 2		E,ED,F,G,S
2H	90	31400-333-004	REGULATOR ASSY. (ND)	1 1 1		
2H	91	31403-323-000	RUBBER, REGULATOR CUSHION	2 2 2		
1G	92	31503-044-670	RUBBER B, BATTERY MOUNTING	1 1 1		
2H	93	31700-124-003	RECTIFIER ASSY., SILICON (STANLEY)	1 1 1		
		31700-124-008	RECTIFIER ASSY., SILICON (SHINDENGEN)	1 1		A,CM
1G	94	31700-333-008	RECTIFIER ASSY., SILICON	1 1 1		
2E	95	32100-377-020	HARNESS, WIRE 32100-377-030	1	1046134	
		32100-377-030	HARNESS, WIRE	1 1	1046135	E,ED,F,G,S
2E	96	32100-377-030	HARNESS, WIRE	1 1		A,CM
2C	97	32123-375-000	CLIP D, WIRE HARNESS	1 1 1		
2H	98	32135-124-300	HOLDER, COUPLER	1 1 1		
2E	99	32161-377-000	BAND, WIRE HARNESS	1 1 1		
2E	100	32174-377-000	HOLDER, WIRE HARNESS	1 1 1		A,CM,OK,DM,U E,ED,F,G,S
2E	101	32174-392-000	HOLDER, WIRE HARNESS	1		A,CM
2E	102	32200-377-671	HARNES, SUB	1 1 1		A,CM
1H	103	32401-333-000	CABLE, STARTER BATTERY	1 1 1		
1H	104	32412-333-000	COVER, BATTERY TERMINAL	1 1 1		
1G	105	32601-286-000	CABLE, BATTERY EARTH	1 1 1		

Block No.	Ref. No.	Part No.	Description	Reqd. No. CH400 F F1 F2	Serial No.	Area Code
1L	106	32983-011-000	GROMMET, WIRE CORD	2 2 2		
1K	107	32985-300-000	GROMMET, WIRE CORD	2 2 2		
1N	108	33100-369-611	HEADLIGHT ASSY. (12V 35/35W 4W)	1	1067421	E,ED,G,S
		33100-369-612	HEADLIGHT ASSY.	1 1	1067422	E,ED,G,S
1Q	109	33100-369-621	HEADLIGHT ASSY. (12V 36/36W 4W)	1 1		F
1A	110	33100-369-671	HEADLIGHT ASSY. (12V 50/35W)	1 1 1		A,CM
2P	111	33100-377-000	HEADLIGHT ASSY. (12V 50/40W)	1		DK,DM,U
2P	112	33101-369-000	RIM, HEADLIGHT	1		DK,DM,U
1N	113	33101-369-620	RIM, HEADLIGHT	1 1		E,ED,F,G,S
1A	114	33101-369-670	RIM, HEADLIGHT	1 1 1		A,CM
1A	115	33103-333-000	SCREW, BEAM ADJUSTING, 4MM	1 1 1		A,CM,DK,DM,U
1A	116	33107-333-000	SPRING, HEADLIGHT BEAM ADJUSTING	1 1 1		A,CM,DK,DM,U
1N	117	33108-369-003	SPRING, HEADLIGHT SETTING	3 3		E,ED,F,G,S
1Q	118	33115-286-621	SPRING, SOCKET HOLDER	1 1		F
1A	119	33117-001-023	NUT, HEADLIGHT BEAM ADJUSTING	1 1 1		A,CM,DK,DM,U
1N	120	33120-268-632	HEADLIGHT UNIT	1 1		E,ED,G,S
1Q	121	33120-286-621	HEADLIGHT UNIT	1 1		F
2P	122	33120-333-000	HEADLIGHT UNIT	1		DK,DM,U
1A	123	33120-333-670	HEADLIGHT UNIT (12V 50/35W)	1 1 1		A,CM
2P	124	33123-333-003	PACKING, BULB	1		DK,DM,U
1A	125	33125-087-761	SCREW, UNIT HOLDER	2 2 2		A,CM,DK,DM,U
1A	126	33128-200-033	NUT, UNIT HOLDER	2 2 2		A,CM,DK,DM,U
1A	127	33130-333-000	SOCKET COMP., HEADLIGHT	1 1 1		A,CM,DK,DM,U
1N	128	33130-369-600	SOCKET, HEADLIGHT	1 1		E,ED,G,S
1Q	129	33130-369-620	SOCKET, HEADLIGHT	1 1		F
2P	130	33131-333-000	HOLDER, HEADLIGHT SOCKET	1		DK,DM,U
2P	131	33132-333-003	WASHER	1		DK,DM,U
2P	132	33140-303-003	SOCKET COMP., POSITION	1		DK,DM,U
1N	133	33170-268-003	SOCKET COMP., MARKER LIGHT	1 1		E,ED,G,S
2N	134	33400-292-612	WINKER ASSY., R. FR.	1 1		G
2P	135	33400-292-670	WINKER ASSY., R. FR.	1		DK,DM,U
1N	136	33400-317-730	WINKER ASSY., R. FR.	1 1		E,ED,F,S
1A	137	33400-377-671	WINKER ASSY., R. FR.	1 1 1		A,CM
1N	138	33401-292-003	BASE, WINKER	4 4		DK,DM,E,ED,F,S,U
1A	139	33401-377-671	BASE, R. FR. WINKER	4 4 4		A,CM
2N	140	33402-268-610	LENS, FR. WINKER	4 4		G
1N	141	33402-268-671	LENS, WINKER	4 2 2		DK,DM,U E,ED,F,S
1A	142	33402-377-671	LENS, FR. WINKER	4 4 4		A,CM
2N	143	33403-285-010	RING, WINKER	4 4		G
2N	144	33404-285-000	SPRING, COIL	4 4		G
1A	145	33405-377-671	SOCKET COMP., R. FR. WINKER	1 1 1		A,CM

FRAME GROUP

Ref. No. 146 ~ 185

Block No.	Ref. No.	Part No.	Description	Reqd. No. CB400 F F1 F2	Serial No.	Area Code
1A	146	33406-377-671	PACKING, WINKER LENS	4 4 4		A,CM
1N	147	33407-284-003	HOLDER, WINKER SOCKET	4 4		DK,DM,E,ED,F,S,U
1A	148	33407-377-671	HOLDER, FR. WINKER SOCKET	4 4 4		A,CM
1N	149	33408-341-701	RUBBER, WINKER CUSHION	4 4		DK,DM,E,ED,F,S,U
2N	150	33410-292-610	SOCKET ASSY., R. FR. WINKER	1 1		G
1N	151	33410-361-003	SOCKET, R. FR. WINKER	1 1		DK,DM,E,ED,F,S,U
1N	152	33443-268-671	PACKING, FR. WINKER LENS	4 4		DK,DM,E,ED,F,S,U
2N	153	33450-292-612	WINKER ASSY., L. FR.	1 1		G
2P	154	33450-292-670	WINKER ASSY., L. FR.	1		DK,DM,U
1N	155	33450-317-730	WINKER ASSY., L. FR.	1 1		E,ED,F,S
1B	156	33450-377-671	WINKER ASSY., L. FR.	1 1 1		A,CM
1A	157	33455-377-671	SOCKET COMP., L. FR. WINKER	1 1 1		A,CM
2N	158	33460-292-610	SOCKET ASSY., L. FR. WINKER	1 1		G
1N	159	33460-361-003	SOCKET COMP., L. WINKER	1 1		DK,DM,E,ED,F,S,U
2N	160	33600-292-611	WINKER ASSY., R. RR.	1 1		G
2P	161	33600-300-000	WINKER ASSY., R. RR.	1		DK,DM,U
1N	162	33600-333-730	WINKER ASSY., R. RR.	1 1		E,ED,F,S
1L	163	33600-377-671	WINKER ASSY., R. RR.	1 1 1		A,CM
1N	164	33602-323-631	LENS, RR. WINKER	2 2		E,ED,F,S
1G	165	33603-053-650	COLLAR, RR. WINKER STAY	4 4 4		
2N	166	33605-292-610	BASE, WINKER	4 4		G
1M	167	33605-377-671	SOCKET COMP., R.	1 1 1		A,CM
1N	168	33607-377-000	STAY, RR. WINKER	2 2		DK,DM,E,ED,F,S,U
1L	169	33607-377-670	STAY, RR. WINKER	2 2 2		A,CM
1L	170	33608-300-000	RUBBER, RR. WINKER MOUNT	2 2 2		A,CM,DK,DM,E,ED,F,S,U
1L	171	33609-292-000	RUBBER B, RR. WINKER MOUNT	2 2 2		A,CM,DK,DM,E,ED,F,S,U
2N	172	33610-292-610	SOCKET ASSY., R. RR. WINKER	1 1		G
1N	173	33610-300-000	SOCKET COMP., R. RR. WINKER	1 1		DK,DM,E,ED,F,S,U
2N	174	33616-304-650	SUB CORD, R. WINKER	1 1		G
2N	175	33650-292-611	WINKER ASSY., L. RR.	1 1		G
2P	176	33650-300-000	WINKER ASSY., L. RR.	1		DK,DM,U
1N	177	33650-333-730	WINKER ASSY., L. RR.	1 1		E,ED,F,S
1M	178	33650-377-671	WINKER ASSY., L. RR.	1 1 1		A,CM
1M	179	33655-377-671	SOCKET COMP., L.	1 1 1		A,CM
2N	180	33660-292-610	SOCKET ASSY., L. RR. WINKER	1 1		G
1N	181	33660-333-003	SOCKET, L. RR. WINKER	1 1		DK,DM,E,ED,F,S,U
2N	182	33666-304-650	SUB CORD, L. RR. WINKER	1 1		G
2N	183	33700-292-610	TAILLIGHT ASSY. (12V 18/5W)	1 1		G
2N	184	33701-051-000	LENS, STOP & TAILLIGHT	1 1		G
1N	185	33701-333-620	TAILLIGHT ASSY.	1 1		E,F ED,S E,F
		33701-333-621	TAILLIGHT UNIT	1	1071520	E,F

Block No.	Ref. No.	Part No.	Description	Reqd. No. CB400 F F1 F2	Serial No.	Area Code
1M	186	33701-342-671	TAILLIGHT UNIT	1 1		A,CM
		33701-341-910	TAILLIGHT UNIT (12V 32/3CP)	1		A,CM
1M	187	33701-344-003	TAILLIGHT UNIT	1	1067005	DK,DM,U
		33701-341-900	TAILLIGHT UNIT	1	1067006	DK,U
1N	188	33702-323-603	LENS, TAILLIGHT	1 1		E,F ED,S
		33702-323-604	LENS, TAILLIGHT	1	1071519	E,F
1M	189	33702-341-003	LENS, TAILLIGHT	1	1071520	E,F
1M	190	33702-341-671	LENS, TAILLIGHT	1 1 1		DK,DM,U
						A,CM
1N	191	33703-333-620	BASE, TAILLIGHT	1 1		E,ED,F,S
1M	192	33703-342-671	BASE COMP., TAILLIGHT	1 1	1067005	DK,U
		33703-341-900	BASE COMP., TAILLIGHT	1 1	1067006	A,CM
2N	193	33707-292-610	CORD COMP., TAILLIGHT	1 1		DK,DM,U
1N	194	33708-077-671	CORD COMP., TAILLIGHT	1 1		A,CM
2N	195	33708-292-610	CORD, STOP LIGHT	1 1		G
1M	196	33708-341-671	CORD COMP., TAILLIGHT	1 1 1		A,CM,DK,DM,U
2N	197	33709-051-000	PACKING, TAILLIGHT LENS	1 1		G
1N	198	33709-077-671	PACKIN, TAILLIGHT LENS	1 1		E,ED,F,S
1M	199	33709-341-671	PACKING, TAILLIGHT LENS	1 1 1		A,CM,DK,DM,U
2N	200	33710-292-610	SOCKET, TAILLIGHT	1 1		G
1L	201	33710-333-000	SUB CORD, STOP LIGHT	1 1 1		A,CM,DK,DM,E,ED,F,S
1L	202	33711-333-000	SUB CORD, TAILLIGHT	1 1 1		A,CM,DK,DM,E,ED,F,S
1L	203	33712-300-003	CORD, TAILLIGHT EARTH	1 1 1		A,CM,DK,DM,E,ED,F,S
2N	204	33715-051-000	LENS, LICENSE	1 1		G
2N	205	33716-051-000	PLATE, INTERCEPTION	1 1		G
2N	206	33717-292-610	BOLT, TAILLIGHT SETTING	2 2		G
1L	207	33719-077-671	PACKING B, TAILLIGHT BASE	2 2 2	1067005	DK,U
						A,CM
		31403-300-000	RUBBER, REGULATOR CUSHION	2 2	1067006	E,ED,F,S
						DK,DM,U
						A,CM
2N	208	33741-333-610	REFLECTOR, REFLEX	1 1	1079668	G
		33741-333-611	REFLECTOR, REFLEX	1	1079669	G
1A	209	33741-340-670	REFLECTOR, FR. REFLEX	2 2 2		A,CM,DK,DM,E,ED,G,S
2N	210	33743-375-000	BASE, FR. REFLECTOR	2 2		G
2P	211	33905-303-003	RUBBER, JOINT	1		DK,DM,U
1Q	212	34901-369-621	BULB, HEADLIGHT (LOCL PROCUREMENT)	1 1		F
2P	213	34901-377-003	BULB, HEADLIGHT (12V 50/40W) (STANLEY)	1		DK,DM,U
1N	214	34901-388-611	BULB, HEADLIGHT (LOCL PROCUREMENT)	1 1		E,ED,G,S
1B	215	34902-259-000	BULB, DASH (12V 3.4W)	9 9 9		